

WATERBUTTS AND RAINGARDENS/SUDS PLANTERS TO BE USED AT RAINWATER DOWNPIPES

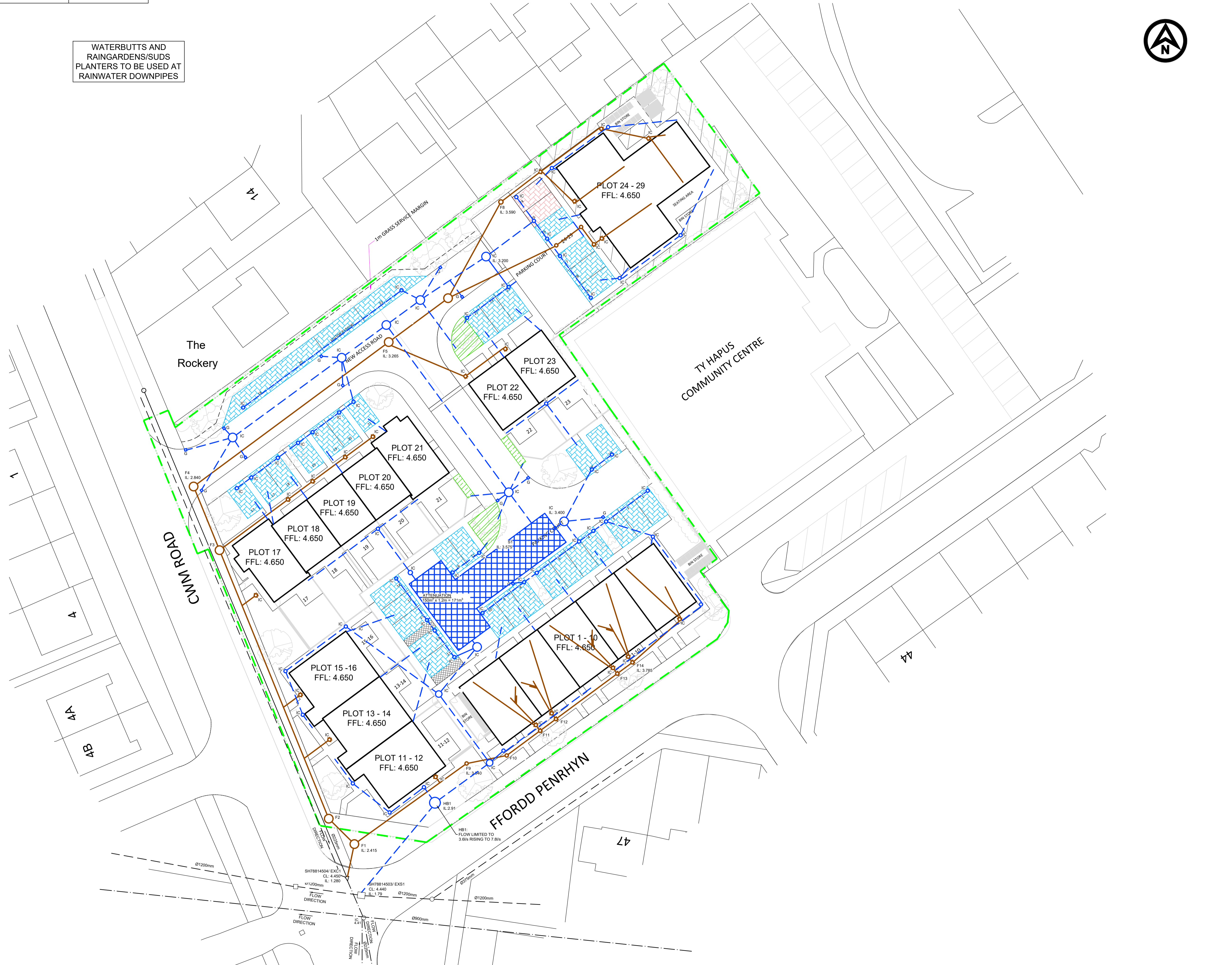

- NOTES**
1. THIS DRAWING IS TO BE READ IN CONJUNCTION WITH ALL RELEVANT ARCHITECTS, ENGINEER'S AND OTHER SPECIALISTS' DRAWINGS.
 2. PLEASE REFER TO ARCHITECTS DRAWINGS FOR FINAL BUILDING LOCATION
 3. ALL DRAINAGE COMPONENTS ARE TO COMPLY WITH CURRENT BRITISH STANDARDS & BUILDING REGULATIONS REQUIREMENTS

KEY

- SITE BOUNDARY
- ASSUMED LINE OF EXISTING FOUL SEWER
- ASSUMED LINE OF EXISTING COMBINED SEWER
- ASSUMED LINE OF EXISTING SURFACE WATER SEWER
- PROPOSED FOUL CHAMBER AND SEWER
- PROPOSED SURFACE WATER CHAMBER AND SEWER
- PROPOSED LAND DRAIN CHAMBER AND PIPE
- PROPOSED PERMEABLE PAVING
- PROPOSED IMPERMEABLE PAVING
- PROPOSED RAINGARDEN
- PROPOSED HYDROPLANTER
- PROPOSED ATTENUATION STORAGE

REV	DATE	DESCRIPTION	BY	CHK	APP
P2	14.01.24	SURFACE WATER LAYOUT AMENDED	LI	AC	AC

PRELIMINARY ISSUE



PROJECT **Housing Development adj. Ty Hapus, Llandudno**

TITLE **Drainage Scheme**

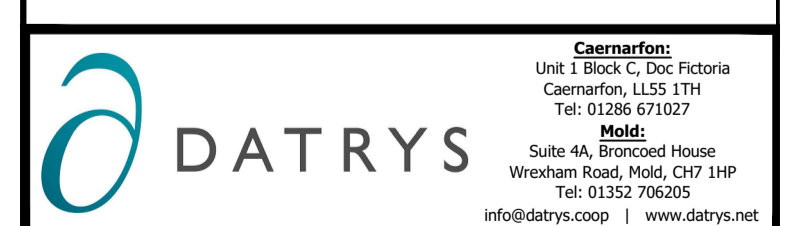

DRAWN LG	CHECKED LI	PASSED EPW
DATE 05.09.24	DATRY'S REF.	
SCALE AT A1 1:250	AUTOCAD REF. 24168/SK501	
DRAWING No. 24168/SK501	REVISION P2	