

KEY

Category A Tree or Group

Category B Tree or Group

Category C Tree or Group

Nominal RPA
(Refer to tables
for constraints)

Theoretical RPA
(Refer to tables
for constraints)

1st Branch
Direction

Group RPA

Note: Tree colour-coding and categories are designed to comply with the conventions set out in BS 5837: 2012 "Trees in relation to design, demolition and construction. Recommendations."

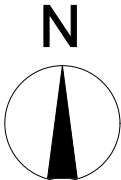
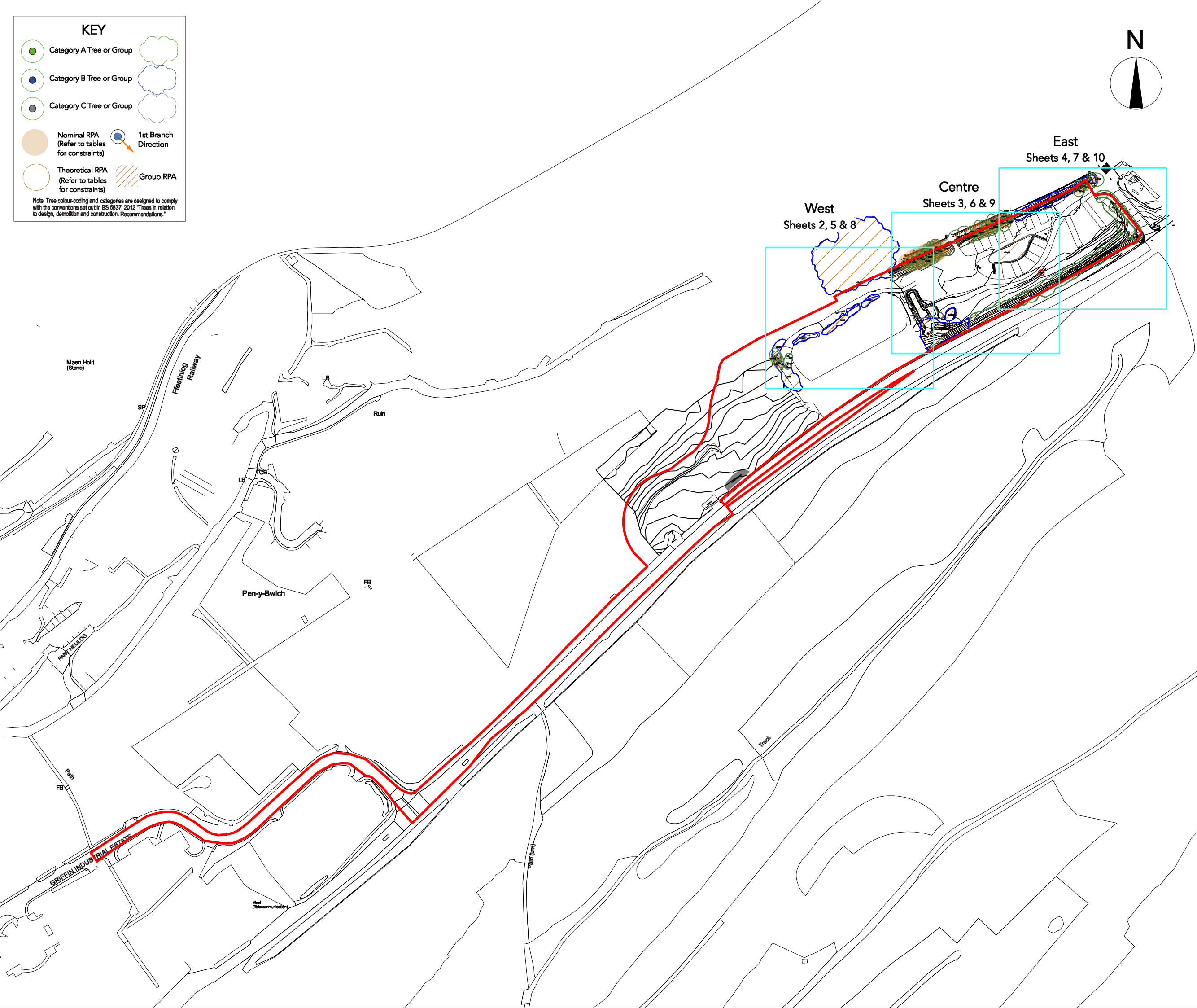

02/11/2023	P05	Amended Red Line
19/10/2023	P04	Revised document number
12/10/2023	P03	Revised Red Line Boundary
02/08/2023	P02	Submission for Planning
12/07/2023	P01	Draft Arboricultural Submission

Date	No.	Zone	Revision Notes
------	-----	------	----------------



WEST COAST

arboriculture &
land planning ltd

Design Firm

West Coast Arboriculture & Land Planning Ltd
Unit 5 Griffiths Crossing Ind. Estate
Griffiths Crossing
Gwynedd
LL55 1TS
www.westcoast-land.co.uk

Project Title

Blaen Cefn Temporary Worker's Accommodation

Sheet Title

Arboricultural Site Overview

Sheet Scale	Sheet Number
1:2,500@ A3	1 of 10
Drawn By	Reviewed By
SF	SF
Sheet No.	Rev.
C0233-HUK-GES-CG-DR-X-0001	P06

File Name

WAL_23_062 Blaen Cefn Arboricultural Submission 02.11.23.vwx

Status code

Code - Description

S1 SHARED - SUITABLE FOR COORDINATION

KEY

Category A Tree or Group

Category B Tree or Group

Category C Tree or Group

Nominal RPA
(Refer to tables
for constraints)

Theoretical RPA
(Refer to tables
for constraints)

1st Branch
Direction

Group RPA

Note: Tree colour-coding and categories are designed to comply
with the conventions set out in BS 5837: 2012 "Trees in relation
to design, demolition and construction. Recommendations."

02/11/2023	P05	Amended Red Line
19/10/2023	P04	Revised document number
12/10/2023	P03	Revised Red Line Boundary
02/08/2023	P02	Submission for Planning
12/07/2023	P01	Draft Arboricultural Submission

Date	No.	Zone	Revision Notes
------	-----	------	----------------



WEST COAST
arboriculture &
land planning ltd

Design Firm

West Coast Arboriculture & Land Planning Ltd
Unit 5 Griffiths Crossing Ind. Estate
Griffiths Crossing
Gwynedd
LL55 1TS
www.westcoast-land.co.uk

Project Title

Blaen Cefn Temporary Worker's Accommodation

Sheet Title

Preliminary Tree Assessment West

Sheet Scale	Sheet Number
1:350 @A3	2 of 10

Drawn By	Reviewed By
SF	SF

Sheet No.	Rev.
C0233-HUK-GES-CG-DR-X-0001	P06

File Name

WAL_23_062 Blaen Cefn Arboricultural Submission 02.11.23.vwx

Status code

Code - Description

S1 SHARED - SUITABLE FOR COORDINATION

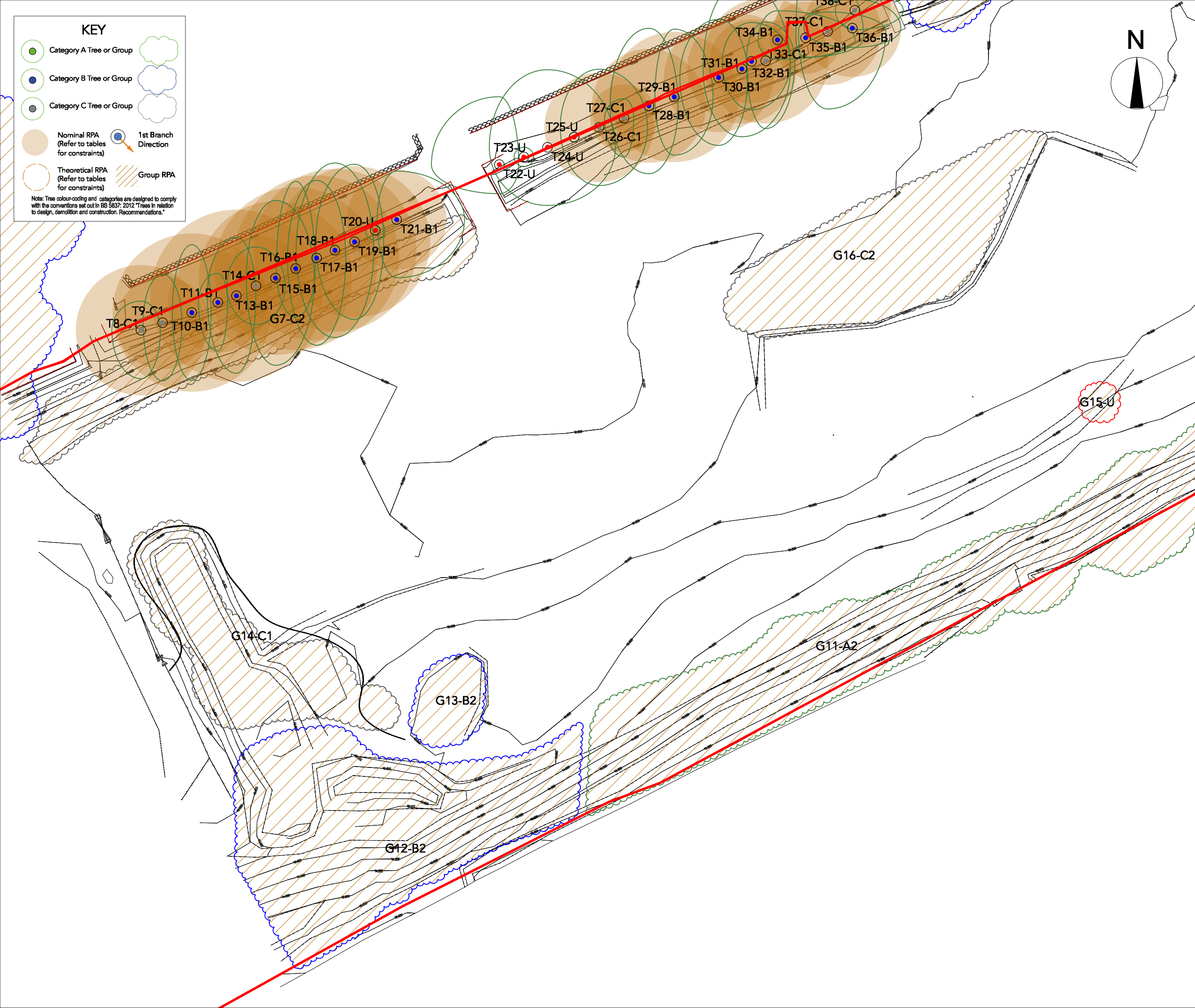

KEY

Category A Tree or Group

Category B Tree or Group

Category C Tree or Group

Nominal RPA
(Refer to tables
for constraints)

Theoretical RPA
(Refer to tables
for constraints)

1st Branch
Direction

Group RPA

Note: Tree colour-coding and categories are designed to comply with the conventions set out in BS 5837: 2012 "Trees in relation to design, demolition and construction. Recommendations."

02/11/2023	P05	Amended Red Line
19/10/2023	P04	Revised document number
12/10/2023	P03	Revised Red Line Boundary
02/08/2023	P02	Submission for Planning
12/07/2023	P01	Draft Arboricultural Submission

Date	No.	Zone	Revision Notes
------	-----	------	----------------



WEST COAST
arboriculture &
land planning ltd

Design Firm

West Coast Arboriculture & Land Planning Ltd
Unit 5 Griffiths Crossing Ind. Estate
Griffiths Crossing
Gwynedd
LL55 1TS
www.westcoast-land.co.uk

Project Title

Blaen Cefn Temporary Worker's Accommodation

Sheet Title

Preliminary Tree Assessment Centre

Sheet Scale	Sheet Number
1:350 @A3	3 of 10

Drawn By	Reviewed By
SF	SF

Sheet No.	Rev.
C0233-HUK-GES-CG-DR-X-0001	P06

File Name

WAL_23_062 Blaen Cefn Arboricultural Submission 02.11.23.vwx

Status code

Code - Description

S1 SHARED - SUITABLE FOR COORDINATION

KEY

Category A Tree or Group

Category B Tree or Group

Category C Tree or Group

Nominal RPA
(Refer to tables
for constraints)

Theoretical RPA
(Refer to tables
for constraints)

1st Branch
Direction

Group RPA

Note: Tree colour-coding and categories are designed to comply with the conventions set out in BS 5837: 2012 "Trees in relation to design, demolition and construction. Recommendations."

A detailed site plan map titled 'Preliminary Tree Assessment East'. The map shows a landscape with various trees and groups of trees. A prominent red line runs diagonally across the map, likely representing a boundary or a proposed path. Several areas are shaded in orange, indicating 'Nominal RPA' (Refer to tables for constraints). Other areas are outlined in green, indicating 'Theoretical RPA' (Refer to tables for constraints). Trees are labeled with codes such as T38-C1, T37-C1, T35-B1, T36-B1, G16-C2, G11-A2, G15-U, G9-A2, T42-U, T43-C1, T44-B1, T46-U, T47-U, T45-U, and G10-A2. A north arrow is located in the top right corner. The map also shows topographical features like contour lines and a road labeled A487.

02/11/2023	P05	Amended Red Line
19/10/2023	P04	Revised document number
12/10/2023	P03	Revised Red Line Boundary
02/08/2023	P02	Submission for Planning
12/07/2023	P01	Draft Arboricultural Submission

Date	No.	Zone	Revision Notes
------	-----	------	----------------



WEST COAST
arboriculture &
land planning ltd

Design Firm

West Coast Arboriculture & Land Planning Ltd
Unit 5 Griffiths Crossing Ind. Estate
Griffiths Crossing
Gwynedd
LL55 1TS
www.westcoast-land.co.uk

Project Title

Blaen Cefn Temporary Worker's Accommodation

Sheet Title

Preliminary Tree Assessment East

Sheet Scale	Sheet Number
1:350 @A3	4 of 10

Drawn By	Reviewed By
SF	SF

Sheet No.	Rev.
C0233-HUK-GES-CG-DR-X-0001	P06

File Name

WAL_23_052 Blaen Cefn Arboricultural Submission 02.11.23.vwx

Status code

S1 SHARED - SUITABLE FOR COORDINATION

Category A Tree or Group

Category B Tree or Group

Category C Tree or Group

Nominal RPA
(Refer to tables
for constraints)

1st Branch
Direction

Tree to be Removed
to Enable the Development

Group or Woodland to be
removed

1

Arboricultural Solutions
Matrix Location

Note: Tree colour-coding and categories are designed to comply with the conventions set out in BS 5837: 2012 "Trees in relation to design, demolition and construction. Recommendations."

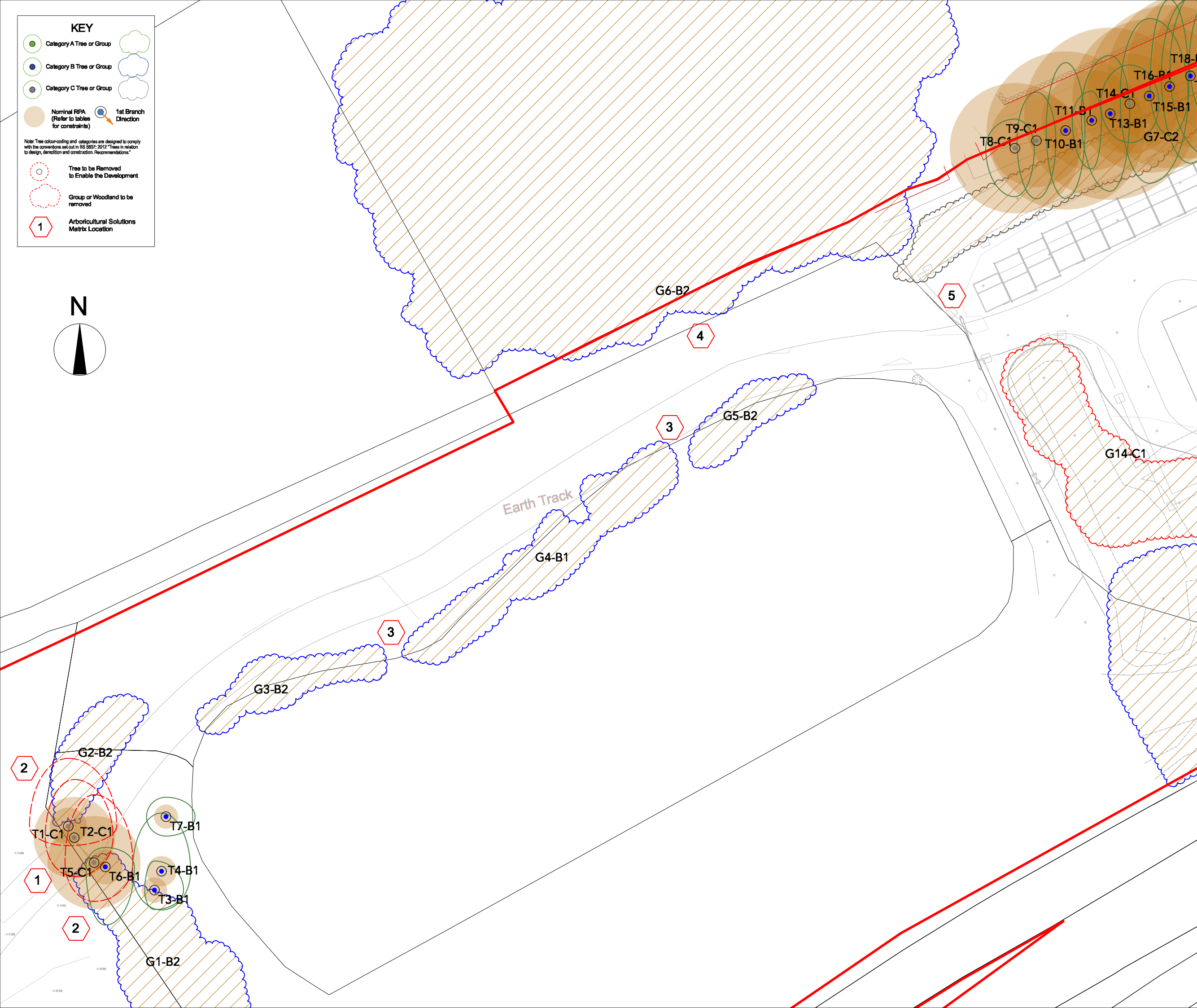
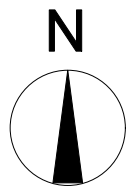

02/11/2023	P05	Amended Red Line
19/10/2023	P04	Revised document number
12/10/2023	P03	Revised Red Line Boundary
02/08/2023	P02	Submission for Planning
12/07/2023	P01	Draft Arboricultural Submission

Date	No.	Zone	Revision Notes
------	-----	------	----------------



WEST COAST
arboriculture &
land planning ltd

Design Firm

West Coast Arboriculture & Land Planning Ltd
Unit 5 Griffiths Crossing Ind. Estate
Griffiths Crossing
Gwynedd
LL55 1TS
www.westcoast-land.co.uk

Project Title

Blaen Cefn Temporary Worker's Accommodation

Sheet Title

Arboricultural Impact Assessment West

Sheet Scale 1:350 @A3	Sheet Number 5 of 10
--------------------------	-------------------------

Drawn By SF	Reviewed By SF
----------------	-------------------

Sheet No. C0233-HUK-GES-CG-DR-X-0001	Rev. P06
---	-------------

File Name
WAL_23_062 Blaen Cefn Arboricultural Submission 02.11.23.vwx

Status code
Code - Description
S1 SHARED - SUITABLE FOR COORDINATION

Category A Tree or Group

Category B Tree or Group

Category C Tree or Group

Nominal RPA
(Refer to tables for constraints)

1st Branch
Direction

Tree to be Removed
to Enable the Development

Group or Woodland to be removed

1

Arboricultural Solutions
Matrix Location

Note: Tree colour-coding and categories are designed to comply with the conventions set out in BS 5837: 2012 "Trees in relation to design, demolition and construction. Recommendations."

02/11/2023	P05	Amended Red Line
18/10/2023	P04	Revised document number
12/10/2023	P03	Revised Red Line Boundary
02/08/2023	P02	Submission for Planning
12/07/2023	P01	Draft Arboricultural Submission

Date	No.	Zone	Revision Notes
------	-----	------	----------------

WEST COAST
arboriculture &
land planning ltd

Design Firm

West Coast Arboriculture & Land Planning Ltd
Unit 5 Griffiths Crossing Ind. Estate
Griffiths Crossing
Gwynedd
LL55 1TS
www.westcoast-land.co.uk

Project Title

Blaen Cefn Temporary Worker's Accommodation

Sheet Title

Arboricultural Impact Assessment Centre

Sheet Scale	Sheet Number
1:350 @A3	6 of 10

Drawn By	Reviewed By
SF	SF

Sheet No.	Rev.
C0233-HUK-GES-CG-DR-X-0001	P06

File Name

WAL_23_062 Blaen Cefn Arboricultural Submission 02.11.23.vwx

Status code

Code- Description

S1 SHARED - SUITABLE FOR COORDINATION

KEY

Category A Tree or Group

Category B Tree or Group

Category C Tree or Group

Nominal RPA
(Refer to tables
for constraints)

1st Branch
Direction

Note: Tree colour-coding and categories are designed to comply with the conventions set out in BS 5837: 2012 "Trees in relation to design, demolition and construction. Recommendations."

Tree to be Removed
to Enable the Development

Group or Woodland to be removed

1

Arboricultural Solutions
Matrix Location

The map illustrates an arboricultural impact assessment for a development. A red line boundary delineates the project area. Various tree groups and individual trees are identified and labeled. Tree groups include G9-B2, G8-B2, G16-C2, G11-A2, G10-A2, and G15-U. Individual trees are labeled T38-C1, T37-C1, T36-B1, T35-B1, T39-C1, T40-C1, T41-C1, T42-U, T43-C1, T44-B1, T46-U, T47-U, and T45-U. A red line boundary runs through the site, separating different areas. A north arrow is located in the top right corner. A key in the top left corner explains the symbols used for tree categories, RPA, branch direction, and removal status. A scale bar in the bottom left corner indicates a scale of 1:350 @A3.

02/11/2023	P05	Amended Red Line
19/10/2023	P04	Revised document number
12/10/2023	P03	Revised Red Line Boundary
02/08/2023	P02	Submission for Planning
12/07/2023	P01	Draft Arboricultural Submission

Date	No.	Zone	Revision Notes
------	-----	------	----------------

WEST COAST
arboriculture &
land planning ltd

Design Firm

West Coast Arboriculture & Land Planning Ltd
Unit 5 Griffiths Crossing Ind. Estate
Griffiths Crossing
Gwynedd
LL55 1TS
www.westcoast-land.co.uk

Project Title

Blaen Cefn Temporary Worker's Accommodation

Sheet Title

Arboricultural Impact Assessment East

Sheet Scale	Sheet Number	Rev.
1:350 @A3	7 of 10	P06
Drawn By	Reviewed By	
SF	SF	
Sheet No.	File Name	
C0233-HUK-GES-CG-DR-X-0001	WAL_23_052 Blaen Cefn Arboricultural Submission 02.11.23.vwx	

Status code

S1 SHARED - SUITABLE FOR COORDINATION

KEY

Category A Tree or Group

Category B Tree or Group

Category C Tree or Group

Note: Tree colour-coding and categories are designed to comply with the conventions set out in BS 5837: 2012 "Trees in relation to design, demolition and construction. Recommendations."

Tree protection fencing

1

Tree Protection Matrix Reference Location

02/11/2023	P05	Amended Red Line
19/10/2023	P04	Revised document number
12/10/2023	P03	Revised Red Line Boundary
02/08/2023	P02	Submission for Planning
12/07/2023	P01	Draft Arboricultural Submission

Date	No.	Zone	Revision Notes
------	-----	------	----------------

Design Firm

West Coast Arboriculture & Land Planning Ltd
Unit 5 Griffiths Crossing Ind. Estate
Griffiths Crossing
Gwynedd
LL55 1TS
www.westcoast-land.co.uk

Project Title

Blaen Cefn Temporary Worker's Accommodation

Sheet Title

Tree Protection Plan West

Sheet Scale	Sheet Number
1:350 @A3	8 of 10

Drawn By	Reviewed By
SF	SF

Sheet No.	Rev.
C0233-HUK-GES-CG-DR-X-0001	P06

File Name

WAL_23_062 Blaen Cefn Arboricultural Submission 02.11.23.vwx

Status code

Code - Description

S1 SHARED - SUITABLE FOR COORDINATION

KEY

Category A Tree or Group

Category B Tree or Group

Category C Tree or Group

Tree protection fencing

1

Tree Protection Matrix Reference Location

Note: Tree colour-coding and categories are designed to comply with the conventions set out in BS 5837: 2012 "Trees in relation to design, demolition and construction. Recommendations."

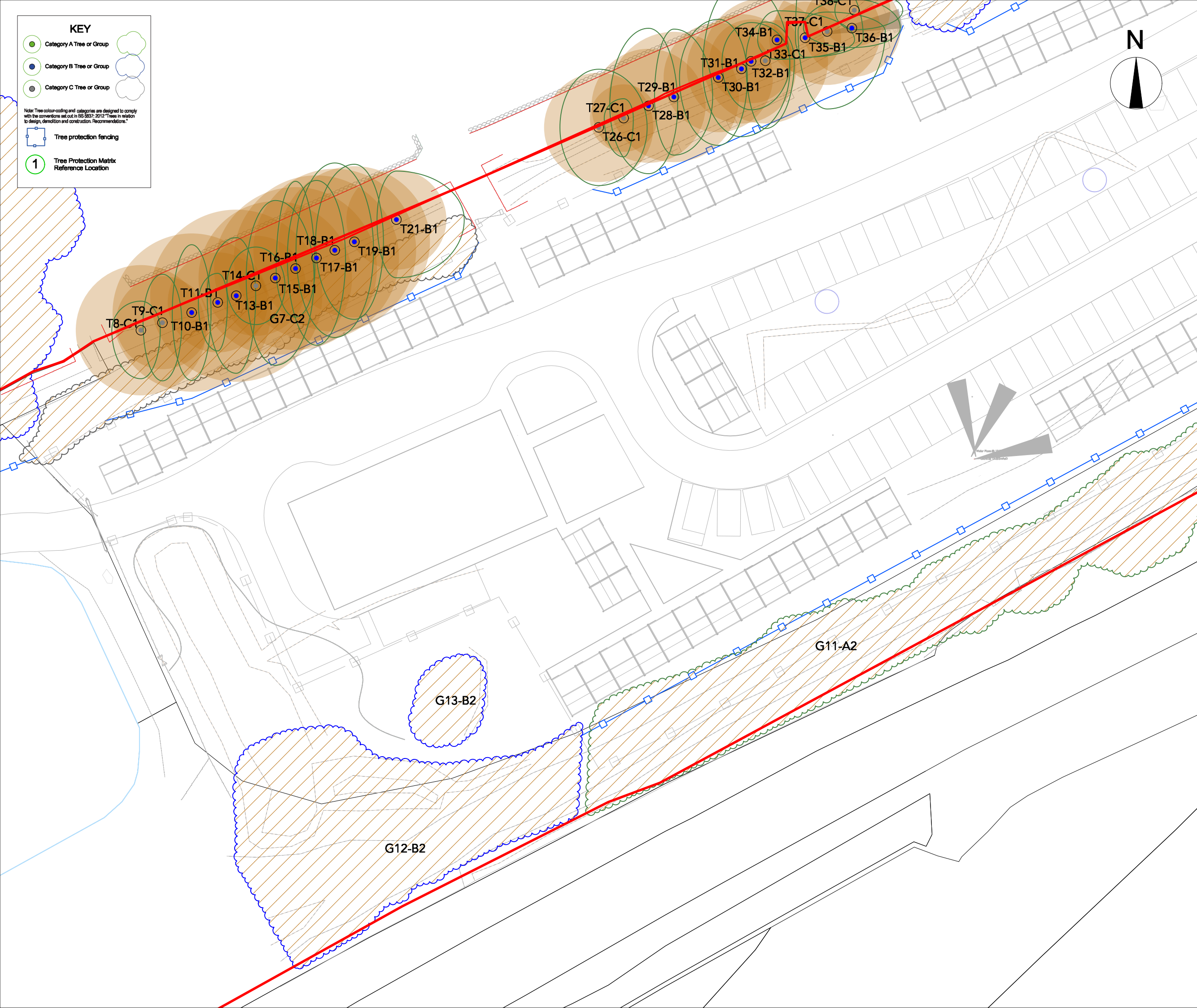

02/11/2023	P05	Amended Red Line
19/10/2023	P04	Revised document number
12/10/2023	P03	Revised Red Line Boundary
02/08/2023	P02	Submission for Planning
12/07/2023	P01	Draft Arboricultural Submission

Date	No.	Zone	Revision Notes
------	-----	------	----------------



WEST COAST
arboriculture &
land planning ltd

Design Firm

West Coast Arboriculture & Land Planning Ltd
Unit 5 Griffiths Crossing Ind. Estate
Griffiths Crossing
Gwynedd
LL55 1TS
www.westcoast-land.co.uk

Project Title

Blaen Cefn Temporary Worker's Accommodation

Sheet Title

Tree Protection Plan Centre

Sheet Scale

1:350 @A3

Sheet Number

9 of 10

Drawn By

SF

Reviewed By

SF

Sheet No.

C0233-HUK-GES-CG-DR-X-0001

Rev.

P06

File Name

WAL_23_062 Blaen Cefn Arboricultural Submission 02.11.23.vwx

Status code

Code - Description

S1 SHARED - SUITABLE FOR COORDINATION

KEY

Category A Tree or Group

Category B Tree or Group

Category C Tree or Group

Note: Tree colour-coding and categories are designed to comply with the conventions set out in BS 5837: 2012 "Trees in relation to design, demolition and construction. Recommendations."

Tree protection fencing

1

Tree Protection Matrix Reference Location

02/11/2023	P05	Amended Red Line
19/10/2023	P04	Revised document number
12/10/2023	P03	Revised Red Line Boundary
02/08/2023	P02	Submission for Planning
12/07/2023	P01	Draft Arboricultural Submission

Date	No.	Zone	Revision Notes
------	-----	------	----------------

Design Firm

West Coast Arboriculture & Land Planning Ltd
Unit 5 Griffiths Crossing Ind. Estate
Griffiths Crossing
Gwynedd
LL55 1TS
www.westcoast-land.co.uk

Project Title

Blaen Cefn Temporary Worker's Accommodation

Sheet Title

Tree Protection Plan East

Sheet Scale	Sheet Number
1:350 @A3	10 of 10

Drawn By	Reviewed By
SF	SF

Sheet No.	Rev.
C0233-HUK-GES-CG-DR-X-0001	P06

File Name

WAL_23_062 Blaen Cefn Arboricultural Submission 02.11.23.vwx

Status code

Code- Description

S1 SHARED - SUITABLE FOR COORDINATION