

1 The Tudor Ground Floor Plan
1:50

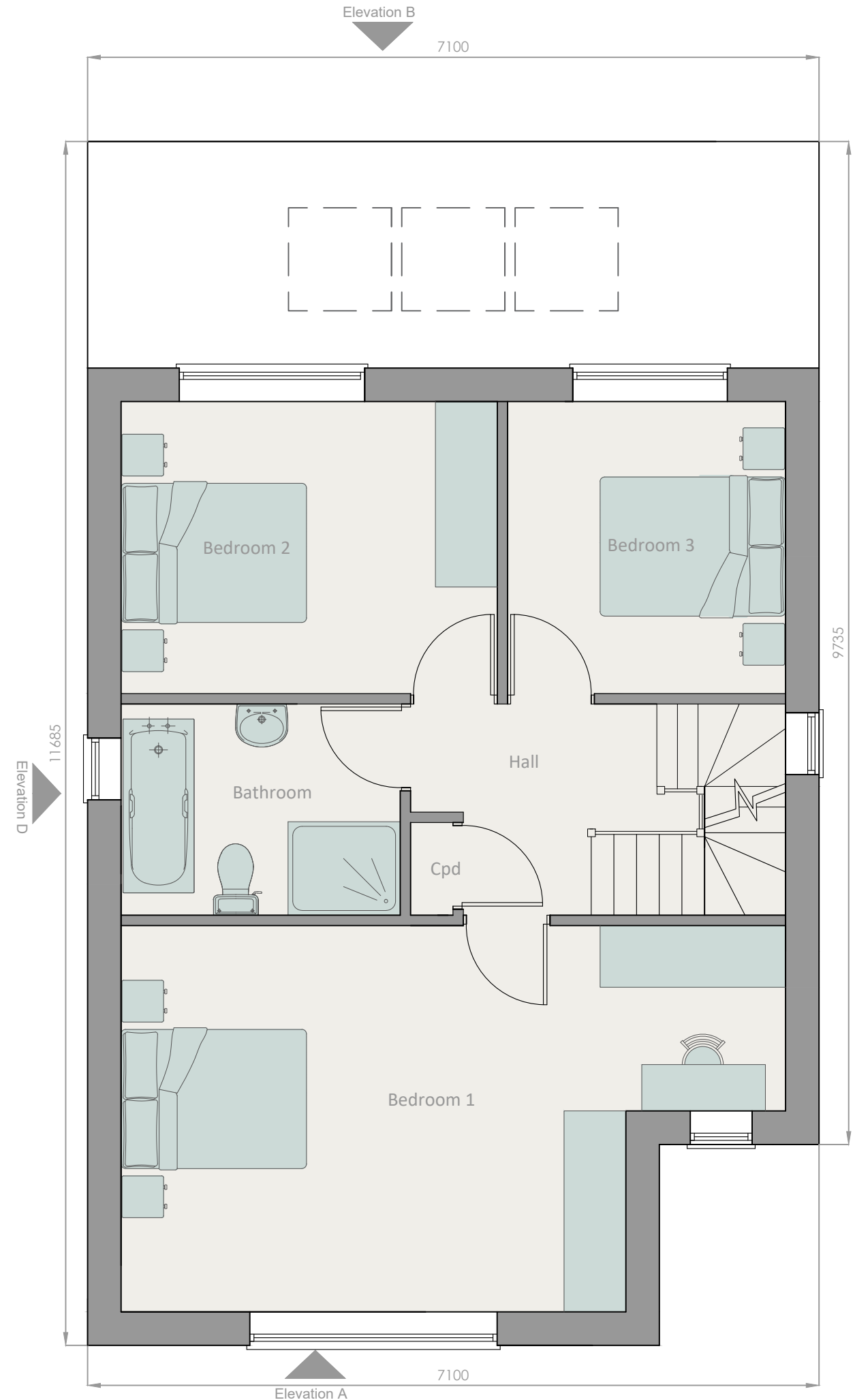

2 The Tudor First Floor Plan
1:50

Penrhyn
Architectural Design
North West
This drawing is to be read in conjunction with the Consultant's drawings. Any discrepancies to be reported to Penrhyn Architectural Design prior to commencement of works. Work from marked dimension only. All dimensions and levels to be checked on site by Contractor.

Rev	Description	By	Date
Status : PLANNING			

Penrhyn
Architectural Design
7 Oakwood
Oak Drive
Colwyn Bay
LL29 7AE

Client : **NORTHFIELD_PROPERTY DEVELOPMENTS**
Project : **OAK_DRIVE RESIDENTIAL DEVELOPMENT**

Drawing : **THE_TUDOR GROUND_&_FIRST FLOOR_PLANS**

Scales : A0 @ A3 @ 1/50 Date : **MAR_22**

Job No.	Drawing No.	Revision
1116	PL01.010	-