

# Rebuild Building 3 - Proposed Building Plans

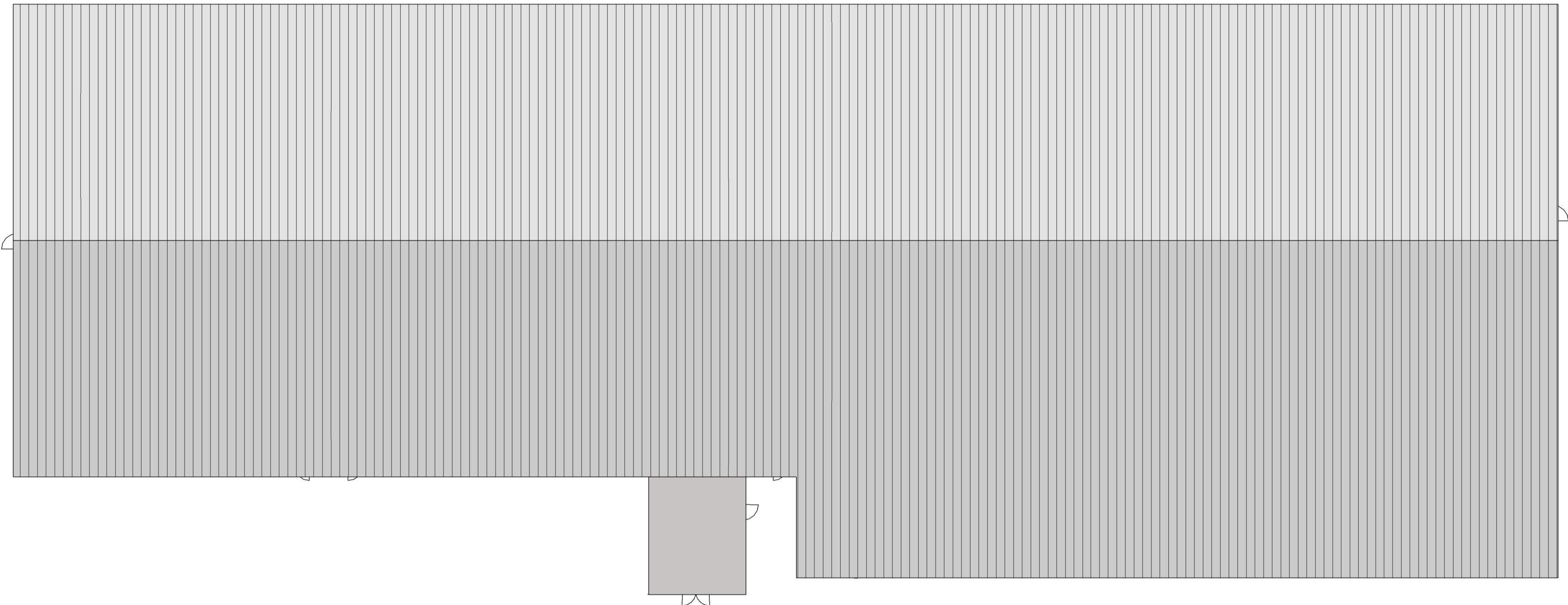

2 | Proposed Rebuilt Building 3 Roof Plan

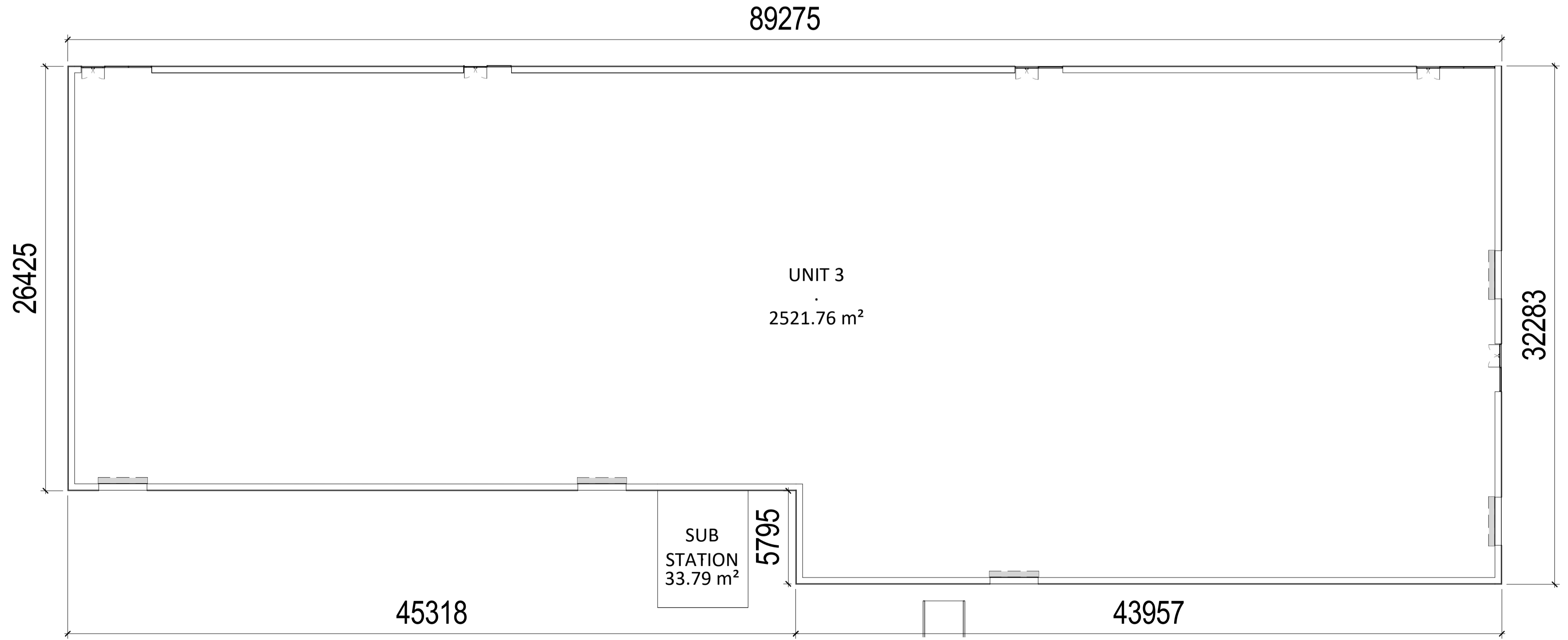

1 | Proposed Rebuilt Building 3 Ground Floor Plan

| Building 3 | Area (External Gross) | Area (GIA)             | Volume (External Gross) |
|------------|-----------------------|------------------------|-------------------------|
| Proposed   | 2,617.9m <sup>2</sup> | 2,521.76m <sup>2</sup> | 18,207.7m <sup>3</sup>  |
| Existing   | 2401 m <sup>2</sup>   | 2,310m <sup>2</sup>    | 13,664.6m <sup>3</sup>  |

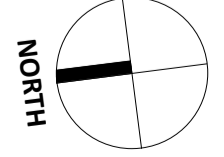
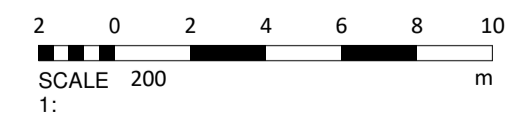

Cheshire Office  
 Old Coach Road, Kelsall, Tarporley, Cheshire, CW6 0QJ  
 T 01829 751555  
 E enquiries@nwdarchitects.co.uk

Client  
 FG Whitley and Sons Co Ltd  
 Project  
 Antelope business Park, Rhydymwyn, CH7 5JH

Title  
 Rebuild Building 3 - Proposed Building Plans

Drawing No 6977-05 Revision A Scale 1:200 Date 27-03-24

Do not scale off this drawing. All dimensions to be checked on site prior to beginning works. Report immediately in writing to project architect if any discrepancies are found between this drawing and information recorded on site or given elsewhere.